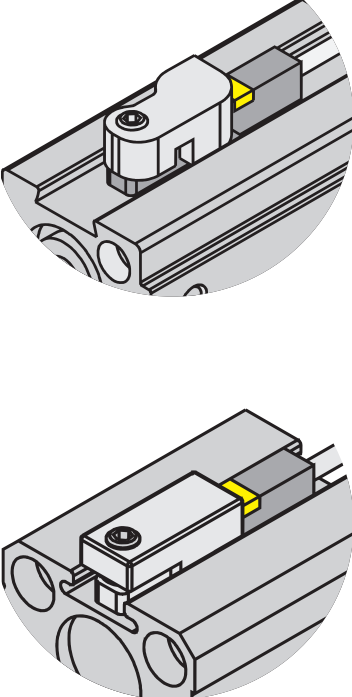

Inductive Cylinder Position Sensors

Drawing	Manufacturer	Cylinder Series	TURCK Sensor	TURCK Bracket
	Numatics	B,F, Compact C), Short Stroke, Rotary Actuator, Pee Wee (O, P, Q), VDMA-V, Ring Series	INT Style	KLDT-1
	PHD	CRS, CTS, O, CVA, CVB, CVC	INT Style	KLDT-2
	Norgren	90000, 91000, 92000, 93000, Lite (A44000)	INT Style	KLDT-5
	Fabco-Air	Global (G, GT)	INT Style	KLDT-3
		Square 1 (SQ, SQF, SQL), Pancake (X,XK, O, OP, XDR, XDRK, ODR), Linear Slide ¹ (GB, L, S, E, SE, EZ, TS) ²	INR Style	KLFA-1 ²
	Compact Air	Inch Series (AB, AS, AR, AT), Inch Series (B, R, S, T) ³ , Ball Slide (BSC), GC, CD, ACLA, ACLAD, (CLA, CLAD) ³ , Metric Series (AWS, AWB, AWT), Metric Series (WS, WB, WT) ³ , B/Base Mount, S/End Mount, R/ End Mount, (CSC, PSC, TCL) ⁴	INT Style	KLDT-8
Turn-Act	Guided-Rod Series	INT	KLDT-9	

1. Some of these may also be equipped to handle 5, 8 or 12 mm inductive proximity sensors.
2. This Mounting is to be used only when "Dovetail Style Mounting Rail" is present on the cylinder.
3. These styles are usually not available with magnets
4. This mounting is to be used only when "Sensor Mounting Rail" is present on the collet.

Drawing	Manufacturer	Cylinder Series	TURCK Sensor	TURCK Bracket
Round Style	Numatics	M	INT Style	KLR-1 or KLR-1M with ASB Clamp ²
			INR Style	KLR-2 with ASB Clamp ²
	Parker	P, SRM, SRDM, XLT, XLR, XLB, (S, SRD) ³	INT Style	KLR-1 or KLR-1M with ASB Clamp ²
			INR Style	KLR-2 with ASB Clamp ²
	Festo	CRDG, CRDSNU, CRDSW, DSNU, DSNUL, DSEU, ESEU, ESNU, ESW, (DSN, DSW, EG, EGZ, ESN) ³	INT Style	KLR-1 or KLR-1M with ASB Clamp ²
			INR Style	KLR-2 with ASB Clamp ²
	Bimba	Original Line II (OL2), Original Line (M, MH, MNR, MC, MRS), Double Wall (DW, DWD, DWN, DWM), PC, Z Series (MO4, MO9, M17, M31), Linear Thrusters (T, TE)	INT Style	KLR-1 or KLR-1M with ASB Clamp ²
			INR Style	KLR-2 with ASB Clamp ²
	SMC	NCM, NCJ2, NCG, NCA1, CJ2, CM2, CG1, MGG	INT Style	KLR-1 or KLR-1M with ASB Clamp ²
			INR Style	KLR-2 with ASB Clamp ²
	Norgren	Round Line (RL)	INT Style	KLR-1 or KLR-1M with ASB Clamp ²
			INR Style	KLR-2 with ASB Clamp ²
	Fabco-Air	Pancake (X, XK, O, OP, XDR, XDRK, ODR), Linear Slide (L, S, E,)	INT Style	KLR-1 or KLR-1M with ASB Clamp ²
			INR Style	KLR-2 with ASB Clamp ²

Cylinder

1. This mounting is to be used only when "Switch Rail" is present on the cylinder.
2. ASB size is determined by the cylinder diameter. See chart below.
3. These styles are usually not available with magnets.

INT Housing with KLR-1 and ASB Style Strap		
Bore Size		Clamp (Stainless Steel)
Inches	mm	
.276-.433	7-11 mm	ASB-1
.433-.748	11-19 mm	ASB-2
.709-1.142	18-29 mm	ASB-3
1.102-1.535	28-39 mm	ASB-4
1.496-1.929	38-49 mm	ASB-5
1.890-2.323	48-59 mm	ASB-6
2.283-2.717	58-69 mm	ASB-7
2.677-3.110	68-79 mm	ASB-8
3.071-3.504	78-89 mm	ASB-9

Inductive Cylinder Position Sensors

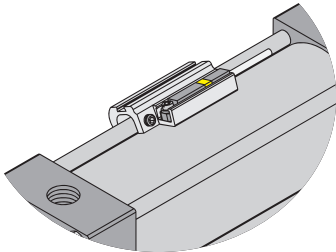
Drawing	Manufacturer	Cylinder Series	TURCK Sensor	TURCK Bracket
	Numatics	A, E, S, L, B Square, VDMA-Z	INT Style	KLZ Series Clamp ¹
	Parker	P5E, HBT, LPM, (S, C, LP) ²	INT Style	KLZ Series Clamp ¹
	PHD	A2, A3, AS, AV, AV2, A3V, AVS, HV, HV2, H3V, HVS, DAV, DHV, EA, EL, EH, ES, NPG, NHG, NEAG, NEHG, TD, (A) ²	INT Style	KLZ Series Clamp ¹
	Festo	DNGU, DNGUL, DNGUT, DNU, DNUL, CRDNG, CRDNGS, DNG, DNGL, DNGZK, DNGZL, DNGZS, DKE	INT Style	KLZ Series Clamp ¹
	Bimba	Flat-I (F0, FOD, FOP, FOR, FOS, FS, FSD, FSR, FSS, F02, F03, F04, Flat-II (FT, FST)	INT Style	KLZ Series Clamp ¹
	SMC	ECQ2, MB, C95	INT Style	KLZ Series Clamp ¹
	Norgren	A, EA, SS, N, J, EJ, 8000/M	INT Style	KLZ Series Clamp ¹
	Turn-Act	NFPA Series	INT Style	KLZ Series Clamp ¹
	Fabco-Air	Long Stroke (321, 521, 721, 1221, S321, S521, S721, S1221), Hi-Power (HP, THP, UHP), Multi-Power (MP, BA, BP), Linear Slide ³ (SE, EZ, TS)	INT Style	KLZ Series Clamp ¹
"T" Groove Style	Parker	P1M, P5T, SST	INT Style	No Additional Bracket Required
			INR Style	KLT-1 Clamp
	Festo	DNC, DNCT, DFM, DPZ, DPZJ, DZF, EZH, ADVU, ADVULQ, ADVUL	INT Style	No Additional Bracket Required
			INR Style	KLT-1 Clamp
	SMC	CUJ, CXS, MGQ, MY1B, MHC, MHL2	INT Style	No Additional Bracket Required
			INR Style	KLT-1 Clamp

1. When using KLZ Series Clamps, user must determine clamp size best suited for application.
2. These styles are usually not available with magnets.
3. Some of these may be equipped to handle 5, 8 or 12 mm inductive proximity sensors.

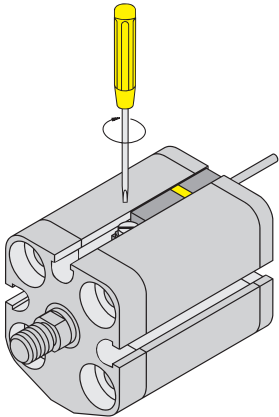
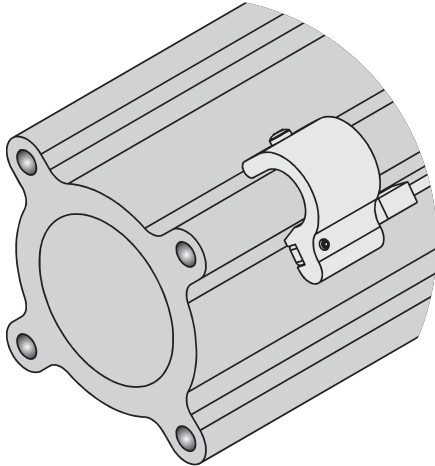
Drawing	Manufacturer	Cylinder Series	TURCK Sensor	TURCK Bracket
<p>Round Groove Style</p> 	Numatics	K	INR Style	No Additional Bracket Required
	Festo	ADVC	INR Style	No Additional Bracket Required
	Bimba	Twin Bore (TB, TBA, TBD), EF1 Series (EF, EFD, EFS, EFR), EF2 Series (EFT), PneuMoment Series (PM)	INR Style	No Additional Bracket Required
	SMC	(CQ2, CQS, NCDQ2, NCQ2) ¹ , (CDQ2) ¹ , CU, CUK, CUW, MU, MHF2, Air slides (MXQ)	INR Style	No Additional Bracket Required
	Compact Air	B, C	INR Style	No Additional Bracket Required
<p>Captive Tie-Rod</p> 	Parker	2MA, 2MAE Bore sizes: 1 1/2" 2", 2 1/2"	INT Style	KL2MA2-INT
		2MA, 2MAE Bore sizes: 3 1/4", 4"		KL2MA1-INT
		MP, MPRL Bore sizes: 25, 32, 40 and 50 mm		KL2MA2-INT
		MP, MPRL Bore sizes: 63, 80 and 100 mm		KL2MA1-INT

Cylinder

1. CQ2, NC(D)Q2, CQS, NCQ2 cylinders may have multiple grooves and may not all be suited for the INR.

Inductive Cylinder Position Sensors

A23 Housing with KLU-1 Clamp

Cylinder Diameter	1.26 - 3.15 inches 32 - 80 mm
Rod Diameter	0.16 - 0.35 inches 4 - 9 mm
Clamp	KLU-1 (Aluminum)

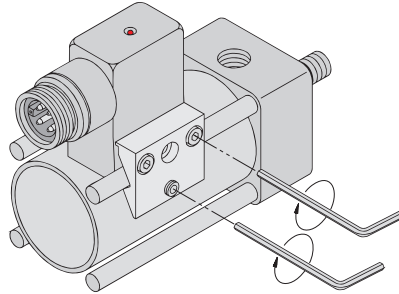

A23 Housing with KLU-2 Clamp

Cylinder Diameter	1.57 - 7.87 inches 40 - 200 mm
Rod Diameter	0.24 - 0.63 inches 6 - 16 mm
Clamp	KLU-2 (Die-cast Zinc)

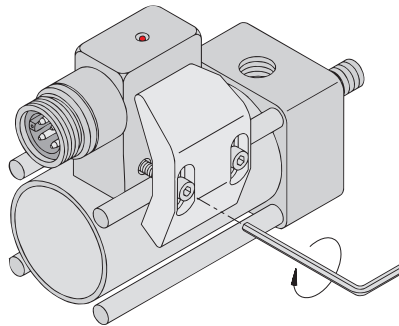

AKT Housing with KLA-1or KLA-3 Clamp

Cylinder Diameter	1.26 - 1.97 inches 32 - 50 mm
Rod Diameter	0.16 - 0.31 inches 4 - 8 mm
Clamp	KLA-1 (Aluminum) KLA-3 (Stainless Steel)

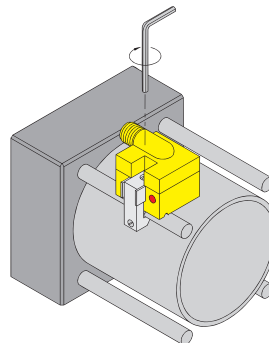

AKT Housing with KLA-2 Clamp

Cylinder Diameter	1.57 - 4.92 inches 40 - 125 mm
Rod Diameter	0.28 - 0.51 inches 7 - 13 mm
Clamp	KLA-2 (Die-cast Zinc)

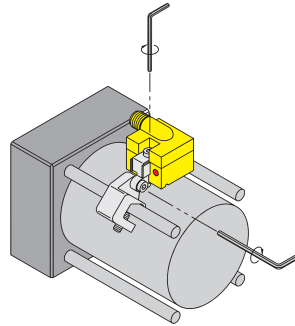

IKE, IKT and IKM Housing with KLI-1 or KLI-3 Clamp

Cylinder Diameter	1.26 - 3.94 inches 32 - 100 mm	2.48 - 6.30 inches 63 - 160 mm
Rod Diameter	0.16 - 0.51 inches 4 - 13 mm	0.24 - 0.63 inches 6 - 16 mm
Clamp	KLI-1 (Die-cast Zinc)	KLI-3 (Die-cast Zinc)

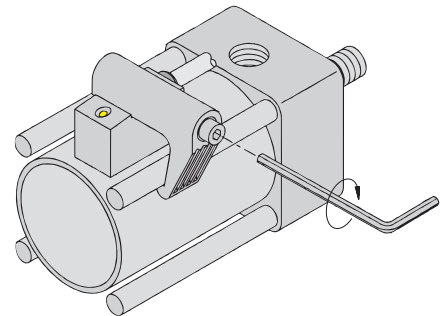

Cylinder

IKE, IKT and IKM Housing with KLI-5Z or KLI-6Z Clamp

Cylinder Diameter	1.26 - 2.48 inches 32 - 63 mm	1.97 - 4.92 inches 50 - 125 mm
Rod Diameter	0.16 - 0.31 inches 4 - 8 mm	0.24 - 0.51 inches 6 - 13 mm
Clamp	KLI-5Z (Aluminum)	KLI-6Z (Aluminum)

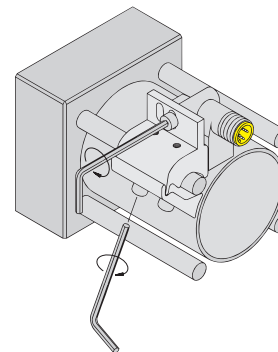

Inductive Cylinder Position Sensors

IKE, IKT and IKM Housing with KLI-2 Clamp

Cylinder Diameter	1.26 - 3.94 inches 32 - 100 mm
Rod Diameter	0.35 - 0.79 inches 9 - 20 mm
Clamp	KLI-2 (Die-cast Zinc)

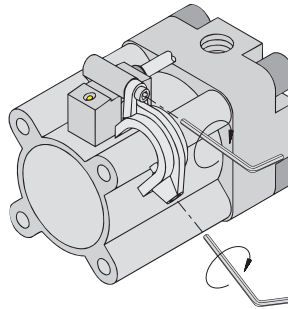

IKE, IKT and IKM Housing with KLI-5 or KLI-6 Clamp

Cylinder Diameter	1.26 - 1.97 inches 32 - 50 mm	1.97 - 3.94 inches 50 - 100 mm
Rod Diameter	0.31 - 0.55 inches 8 - 14 mm	0.43 - 0.75 inches 11 - 19 mm
Clamp	KLI-5 (Aluminum)	KLI-6 (Aluminum)

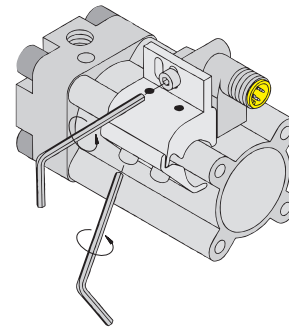

IKE, IKT and IKM Housing with KLI-CB64 or KLI-CB124 Clamp

Cylinder Diameter	0.79 - 2.52 inches 20 - 64 mm	0.79 - 4.88 inches 20 - 124 mm
Clamp	KLI-CB64 (Stainless Steel/Steel)	KLI-CB124 (Stainless Steel/Steel)

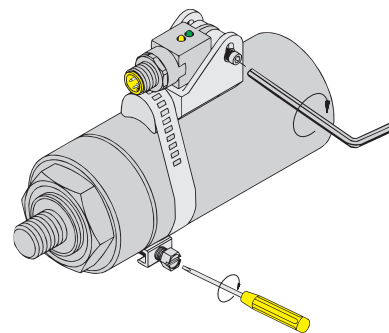

KST Housing with KST-SB170 and KST-SB335 Clamps

Cylinder Diameter	0.31 - 0.99 inches 8 - 25 mm	0.31 - 3.15 inches 8 - 80 mm
Clamp	KST-SB170 (Stainless Steel)	KST-SB335 (Stainless Steel)

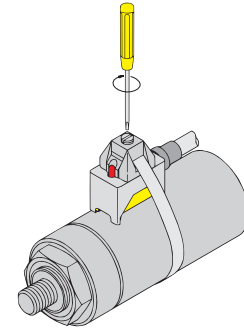

PSM Housing with ASB Style Strap

Bore		Clamp (Stainless Steel)	Cylinder Diameter
Inches	mm		
5/16	8	ASB-3	0-20 mm
3/8	10		
7/16	12		
5/8	16	ASB-4	15-30 mm
3/4	20		
1	25	ASB-5	25-40 mm
1-1/4	32		
1-1/2	40	ASB-6	35-50 mm
2	50	ASB-7	45-60 mm
2-1/2	63	ASB-9	55-80 mm

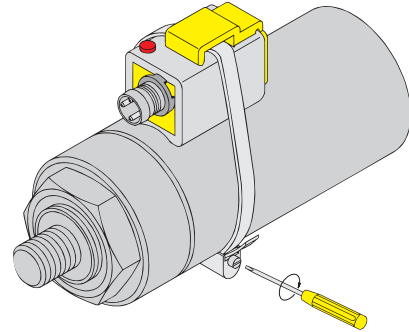

Cylinder

PST Housing with KLP80-VA and KLP200-VA Clamps

Cylinder Diameter	0.31 - 3.15 inches 8 - 80 mm	3.15 - 7.87 inches 80 - 200 mm
Clamp	KLP80-VA* (Stainless steel band, brass nuts)	KLP200-VA (Stainless steel band, brass nuts)

* Clamp included with sensor.

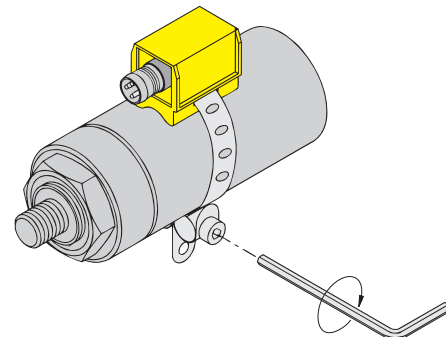

Inductive Cylinder Position Sensors

QST Housing with KLQ-1Z or KLQ-2Z Clamps

Cylinder Diameter	1.26 - 2.48 inches 32 - 63 mm	1.97 - 4.92 inches 50 - 125 mm
Rod Diameter	0.16 - 0.31 inches 4 - 8 mm	0.24 - 0.51 inches 6 - 13 mm
Clamp	KLQ-1Z (Anodized Aluminum)	KLQ-2Z (Anodized Aluminum)

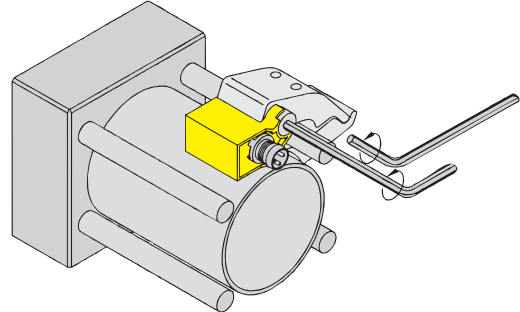

QST Housing with KLQ-1 or KLQ-2 Clamps

Cylinder Diameter	1.26 - 1.97 inches 32 - 50 mm	1.97 - 3.94 inches 50 - 100 mm
Rod Diameter	0.31 - 0.55 inches 8 - 14 mm	0.43 - 0.75 inches 11 - 19 mm
Clamp	KLQ-1 (Anodized Aluminum)	KLQ-2 (Anodized Aluminum)

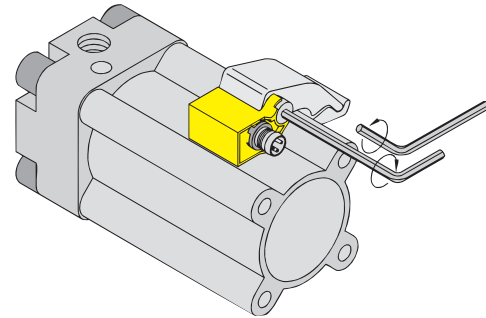

NST Housing with SMC-325 Clamp

Cylinder Diameter	0.47 - 3.94 inches 12 - 100 mm
Cylinder Manufacturer	SMC
Cylinder Family	NCDQ2
Clamp	SMC-325 (Anodized Aluminum)

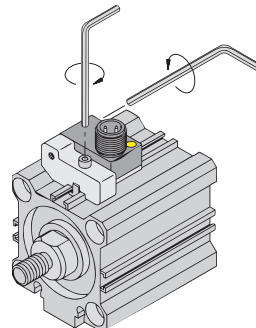

NST Housing with KLN-3 Clamp	
Cylinder Diameter	0.47 - 3.94 inches 12 - 100 mm
Groove Diameter	0.20 - 0.53 (0.83) inches 5.2 - 13.5 (21)* mm
Clamp	KLN-3 (Anodized Aluminum)
*Accessory	Longer M5 x 35 set screw (A0050)

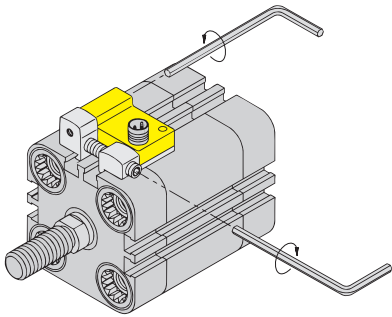

NST Housing with KLN-3 Clamp	
Cylinder Diameter	0.47 - 3.94 inches 12 - 100 mm
Groove Diameter	0.20 - 0.53 (0.83) inches 5.2 - 13.5 (21)* mm
Clamp	KLN-3 (Anodized Aluminum)
*Accessory	Longer M5 x 35 set screw (A0050)

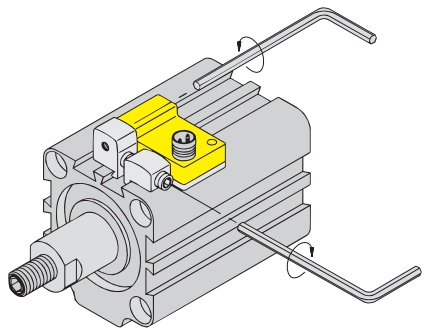

Cylinder

M12 and EG08 Barrel Housing	
<p>When using magnet part number DMR31-15-5, sensing ranges up to 90 mm with BIM-M12 and 78 mm with BIM-EG08 can be achieved. See Accessories section for magnet part numbers.</p>	